

Product No. : EYLGULM330

◆ Dimensions

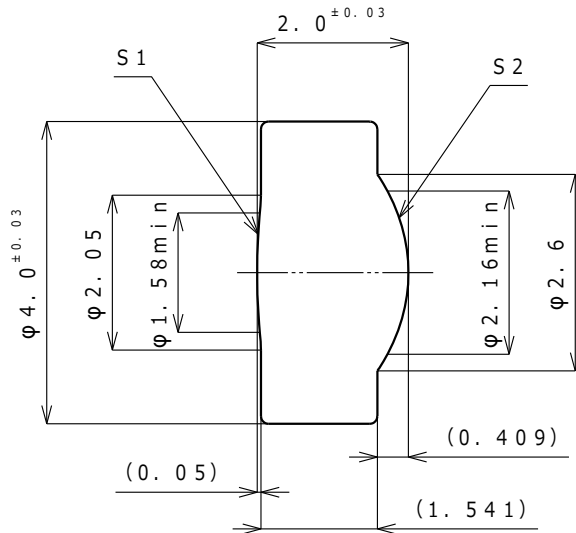

◆ Optical Characteristics

	Items	Unit	Design
1	Design wavelength	nm	780
2	Focal length	mm	3.59
3	Numerical aperture	S1	0.29
4		S2	-
5	Magnification		∞
6	Working distance (L1)	mm	2.55 *1)
7	Conjugate distance (L2)	mm	-
8	Effective diameter	S1	$\phi 1.58$
9		S2	$\phi 2.16$
10	Transmittance (at 630-800nm)	%	≥ 97
11	Wavefront aberration	λ_{rms}	≤ 0.060

Remarks:

*1) Including cover glass(BK7/t0.25mm)

◆ Materials

Glass material	K-PBK40
Barrel material	