

Product No. : EYLGULF292

◆ Dimensions

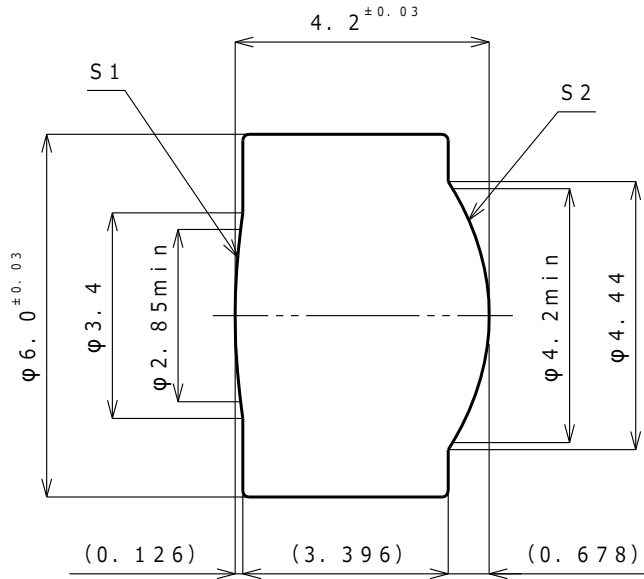

◆ Optical Characteristics

	Items	Unit	Design
1	Design wavelength	nm	780
2	Focal length	mm	6.00
3	Numerical aperture	S1	0.35
4		S2	-
5	Magnification		∞
6	Working distance (L1)	mm	3.82 *1)
7	Conjugate distance (L2)	mm	-
8	Effective diameter	S1	Φ2.85
9		S2	Φ4.20
10	Transmittance (at 660-700nm)	%	≥95
11	Wavefront aberration	λ_{rms}	≤0.060

Remarks:

*1)Including cover glass(BK7/t0.27mm)

◆ Materials

Glass material	K-PBK40
Barrel material	