

Conductive Polymer Hybrid Aluminum Electrolytic Capacitor Technical Data ZK series



Data Sheet

Conductive Polymer Hybrid Aluminum Electrolytic Capacitor

SMD type ZK series



Patr No.	Voltaeg / Cap.		Size		Page	
EEHZK1E470R	25 V	47 μ F	Φ	5 x 5.8	...	ZK 1
EEHZK1E680P	25 V	68 μ F	Φ	6 x 5.8	...	ZK 2
EEHZK1E820P	25 V	82 μ F	Φ	6 x 5.8	...	ZK 3
EEHZK1E151XP	25 V	150 μ F	Φ	6 x 7.7	...	ZK 4
EEHZK1E271P	25 V	270 μ F	Φ	8 x 10.2	...	ZK 5
EEHZK1E471P	25 V	470 μ F	Φ	10 x 10.2	...	ZK 6
EEHZK1V330R	35 V	33 μ F	Φ	5 x 5.8	...	ZK 7
EEHZK1V560P	35 V	56 μ F	Φ	6 x 5.8	...	ZK 8
EEHZK1V101XP	35 V	100 μ F	Φ	6 x 7.7	...	ZK 9
EEHZK1V181P	35 V	180 μ F	Φ	8 x 10.2	...	ZK 10
EEHZK1V331P	35 V	330 μ F	Φ	10 x 10.2	...	ZK 11

Data Sheet

Conductive Polymer Hybrid Aluminum Electrolytic Capacitor

SMD type ZK series

Part Number : EEHZK1E470R

Endurance: 125 °C, 4000 h

Category Temperature Range	-55 °C to 125 °C
Rated Voltage	25 V
Nominal Capacitance	47 μF (at 120 Hz)
Capacitance Tolerance	±20 %

tan δ	0.14 max. (at 120 Hz)
Leakage Current	11.7 μA max. (at R.V., After 2 min)
ESR	80 mΩ max. (at 100 kHz, 20 °C)
Ripple Current	850 mA rms max. (at 100 kHz, 125 °C)

Marking

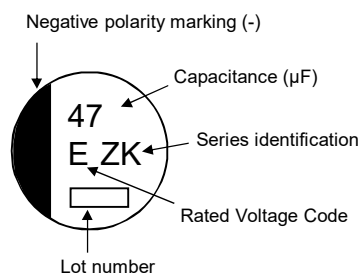

Dimensions in mm (not to scale)

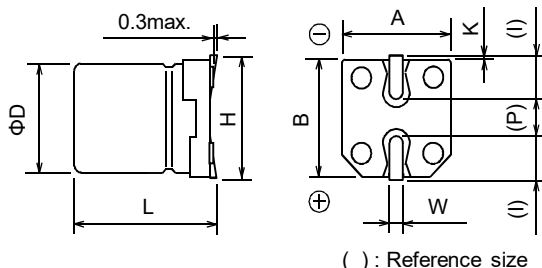

Size Code: C (Unit: mm)

ΦD	5.0 ±0.5
L	5.8 ±0.3
A, B	5.3 ±0.2
H	6.5 max.
I	2.2
W	0.65 ±0.10
P	1.5
K	0.35 +0.15/-0.20

Frequency vs. Impedance, ESR, ESL, Capacitance, tanδ Characteristics

Osc. Level: 0.5 Vrms (at no load)

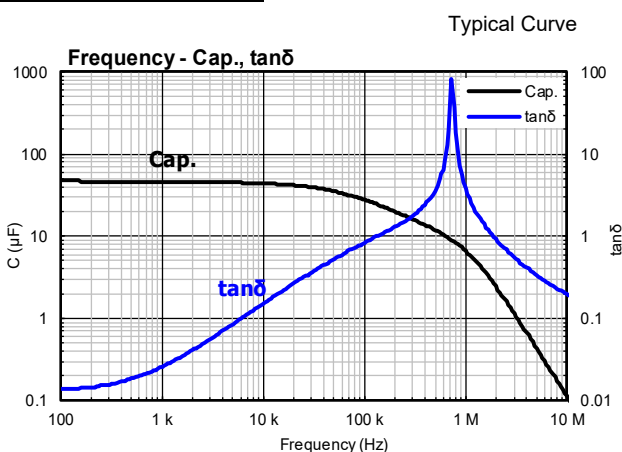
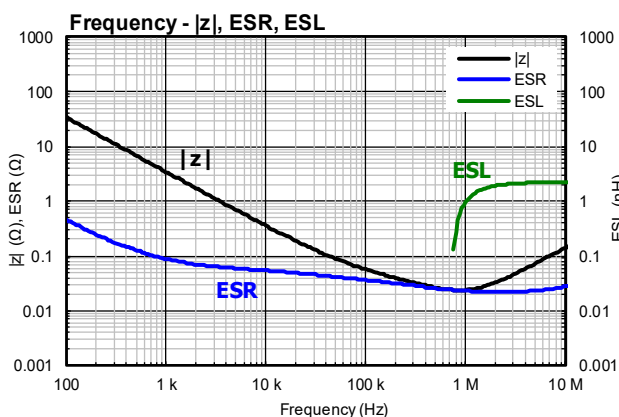

Temperature vs. Capacitance, tanδ, ESR Characteristics

Osc. Level: 0.5 Vrms (at no load)

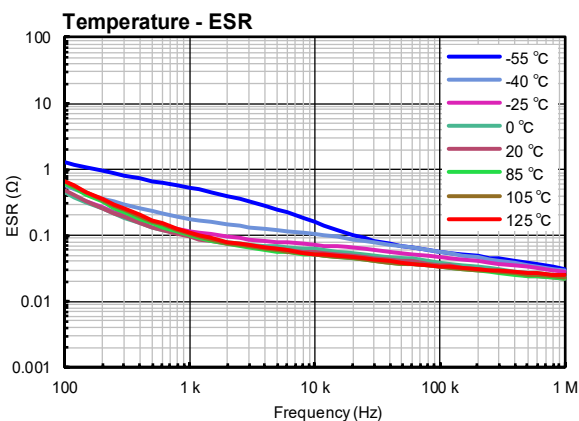
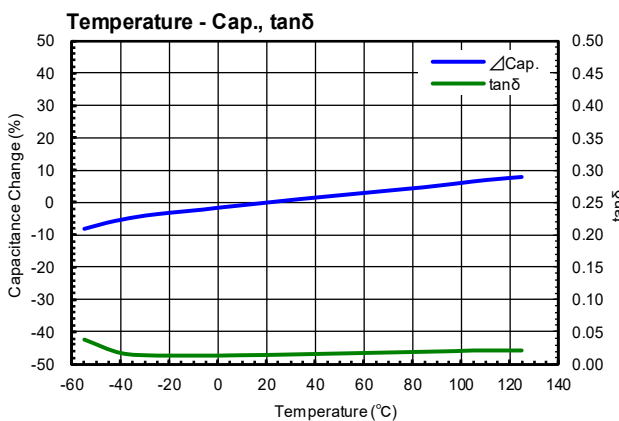

Data Sheet

Conductive Polymer Hybrid Aluminum Electrolytic Capacitor

SMD type ZK series

Part Number : EEHZK1E680P

Endurance: 125 °C, 4000 h

Category Temperature Range	-55 °C to 125 °C
Rated Voltage	25 V
Nominal Capacitance	68 μF (at 120 Hz)
Capacitance Tolerance	±20 %

tan δ	0.14 max. (at 120 Hz)
Leakage Current	17.0 μA max. (at R.V., After 2 min)
ESR	50 mΩ max. (at 100 kHz, 20 °C)
Ripple Current	1300 mA rms max. (at 100 kHz, 125 °C)

Marking

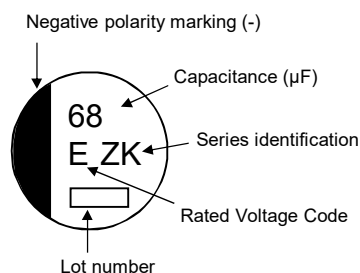

Dimensions in mm (not to scale)

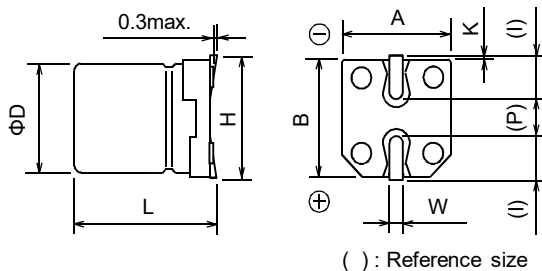

Size Code: D (Unit: mm)

ϕD	6.3 ±0.5
L	5.8 ±0.3
A, B	6.6 ±0.2
H	7.8 max.
I	2.6
W	0.65 ±0.10
P	1.8
K	0.35 +0.15/-0.20

Frequency vs. Impedance, ESR, ESL, Capacitance, tanδ Characteristics

Osc. Level: 0.5 Vrms (at no load)

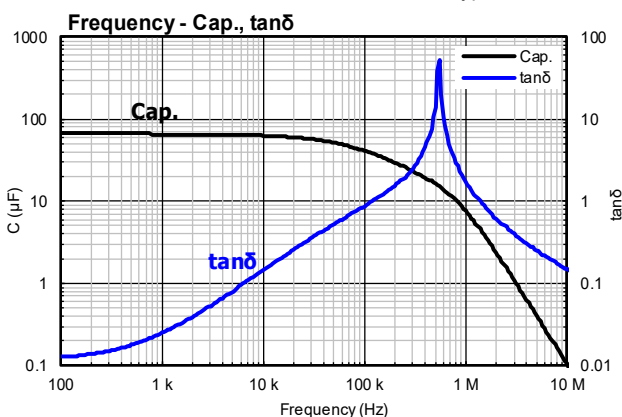
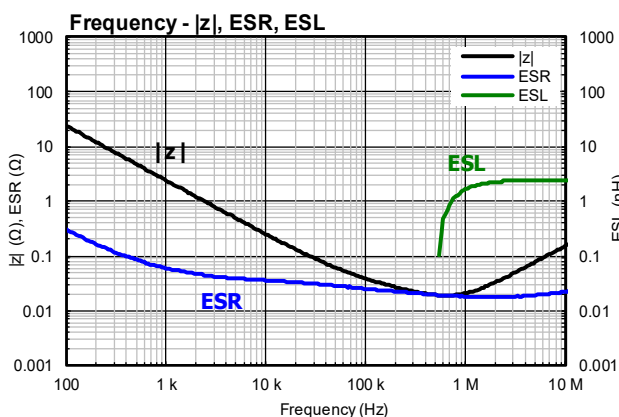

Temperature vs. Capacitance, tanδ, ESR Characteristics

Osc. Level: 0.5 Vrms (at no load)

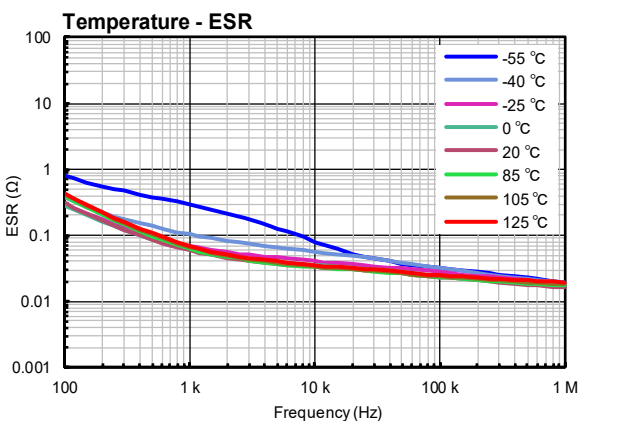
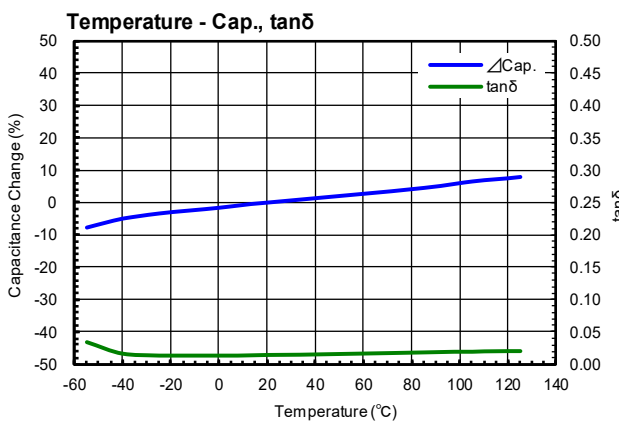

Data Sheet

Conductive Polymer Hybrid Aluminum Electrolytic Capacitor

SMD type ZK series

Part Number : EEHZK1E820P

Endurance: 125 °C, 4000 h

Category Temperature Range	-55 °C to 125 °C
Rated Voltage	25 V
Nominal Capacitance	82 μF (at 120 Hz)
Capacitance Tolerance	±20 %

tan δ	0.14 max. (at 120 Hz)
Leakage Current	20.5 μA max. (at R.V., After 2 min)
ESR	50 mΩ max. (at 100 kHz, 20 °C)
Ripple Current	1300 mA rms max. (at 100 kHz, 125 °C)

Marking

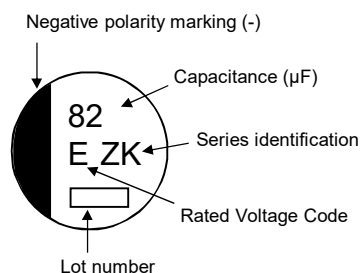

Dimensions in mm (not to scale)

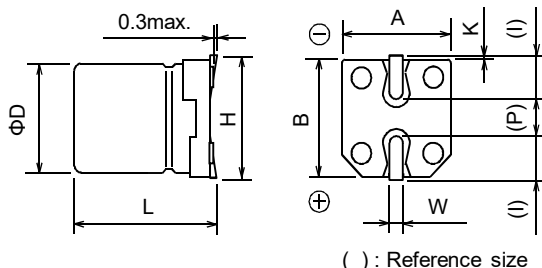

Size Code: D (Unit: mm)

ϕD	6.3 ±0.5
L	5.8 ±0.3
A, B	6.6 ±0.2
H	7.8 max.
I	2.6
W	0.65 ±0.10
P	1.8
K	0.35 +0.15/-0.20

Frequency vs. Impedance, ESR, ESL, Capacitance, tanδ Characteristics

Osc. Level: 0.5 Vrms (at no load)

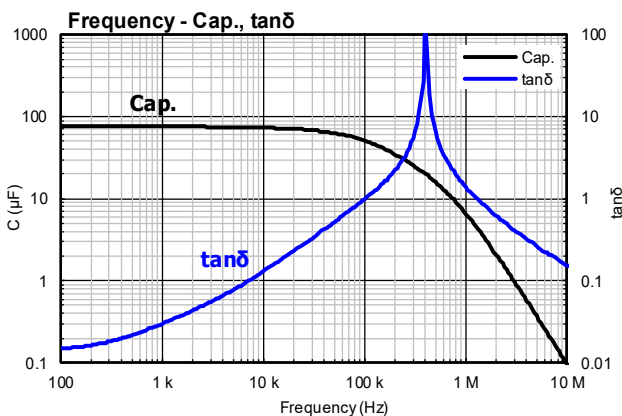
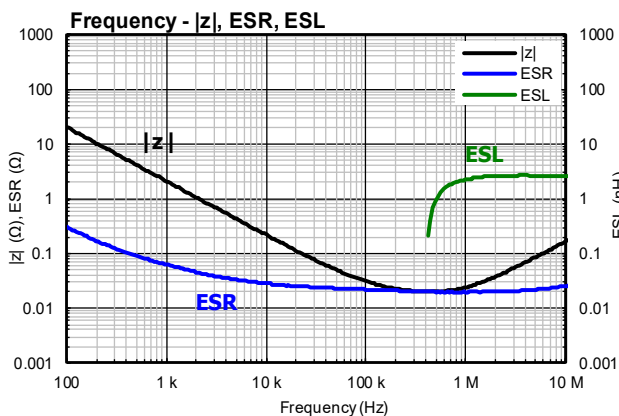

Temperature vs. Capacitance, tanδ, ESR Characteristics

Osc. Level: 0.5 Vrms (at no load)

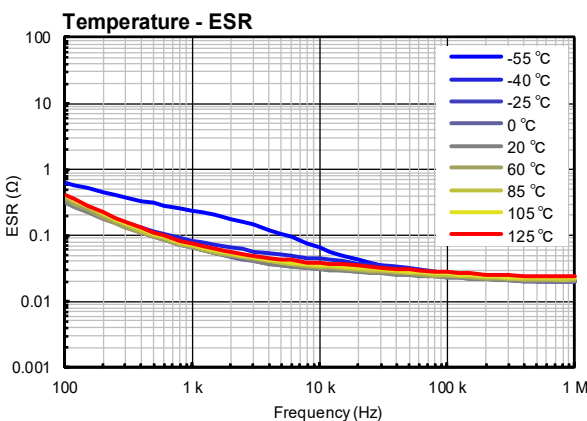
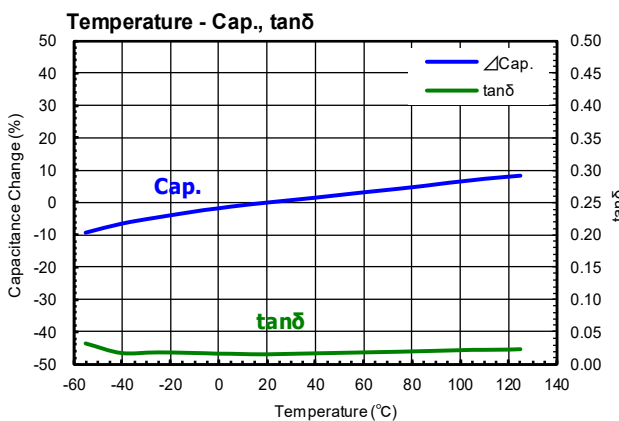

Data Sheet

Conductive Polymer Hybrid Aluminum Electrolytic Capacitor

SMD type ZK series

Part Number : EEHZK1E151XP

Endurance: 125 °C, 4000 h

Category Temperature Range	-55 °C to 125 °C
Rated Voltage	25 V
Nominal Capacitance	150 μF (at 120 Hz)
Capacitance Tolerance	±20 %

tan δ	0.14 max. (at 120 Hz)
Leakage Current	37.5 μA max. (at R.V., After 2 min)
ESR	30 mΩ max. (at 100 kHz, 20 °C)
Ripple Current	1800 mA rms max. (at 100 kHz, 125 °C)

Marking

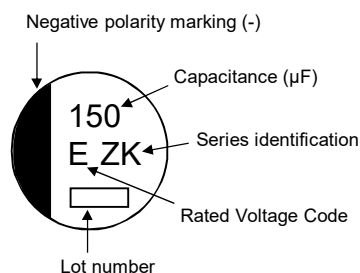

Dimensions in mm (not to scale)

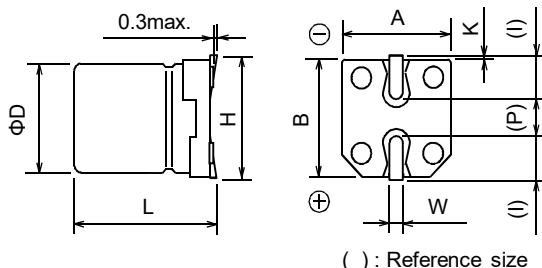

Size Code: D8 (Unit: mm)

ΦD	6.3 ±0.5
L	7.7 ±0.3
A, B	6.6 ±0.2
H	7.8 max.
I	2.6
W	0.65 ±0.10
P	1.8
K	0.35 +0.15/-0.20

Frequency vs. Impedance, ESR, ESL, Capacitance, tanδ Characteristics

Osc. Level: 0.5 Vrms (at no load)

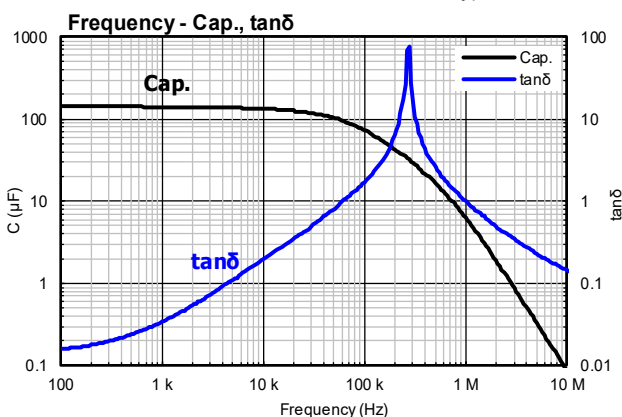
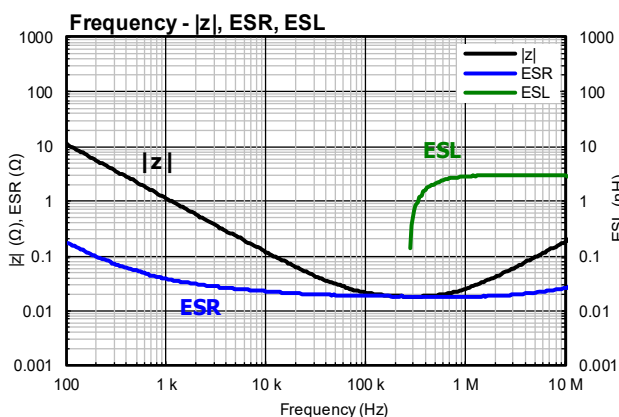

Temperature vs. Capacitance, tanδ, ESR Characteristics

Osc. Level: 0.5 Vrms (at no load)

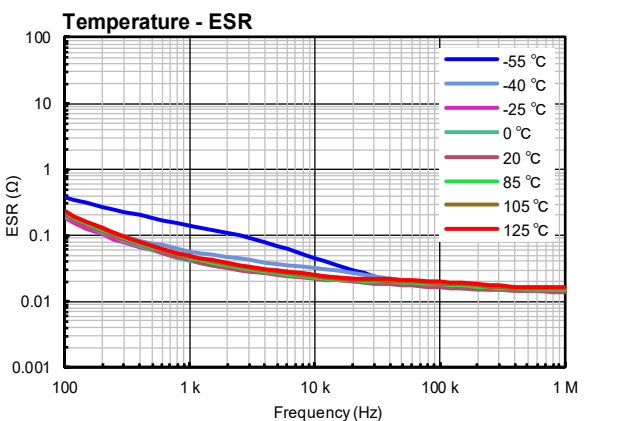
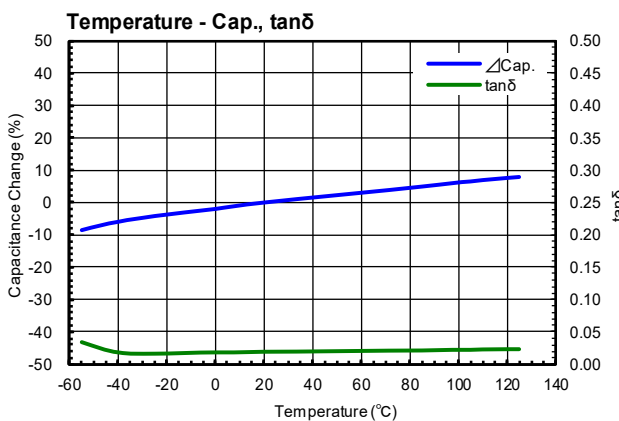

Data Sheet

Conductive Polymer Hybrid Aluminum Electrolytic Capacitor

SMD type ZK series

Part Number : EEHZK1E271P

Endurance: 125 °C, 4000 h

Category Temperature Range	-55 °C to 125 °C
Rated Voltage	25 V
Nominal Capacitance	270 μF (at 120 Hz)
Capacitance Tolerance	±20 %

tan δ	0.14 max. (at 120 Hz)
Leakage Current	67.5 μA max. (at R.V., After 2 min)
ESR	27 mΩ max. (at 100 kHz, 20 °C)
Ripple Current	2000 mA rms max. (at 100 kHz, 125 °C)

Marking

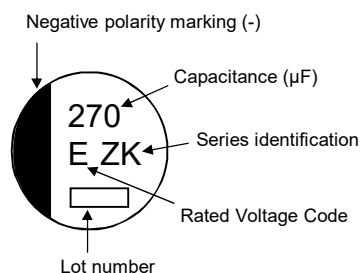

Dimensions in mm (not to scale)

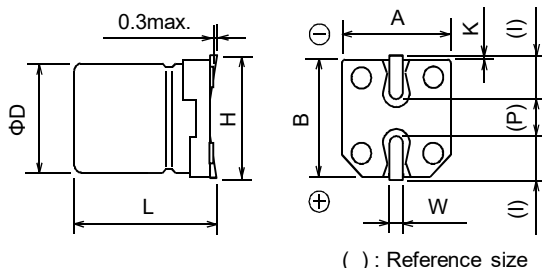

Size Code: F (Unit: mm)

ϕD	8.0 ±0.5
L	10.2 ±0.3
A, B	8.3 ±0.2
H	10.0 max.
I	3.4
W	0.90 ±0.20
P	3.1
K	0.70 ±0.2

Frequency vs. Impedance, ESR, ESL, Capacitance, tanδ Characteristics

Osc. Level: 0.5 Vrms (at no load)

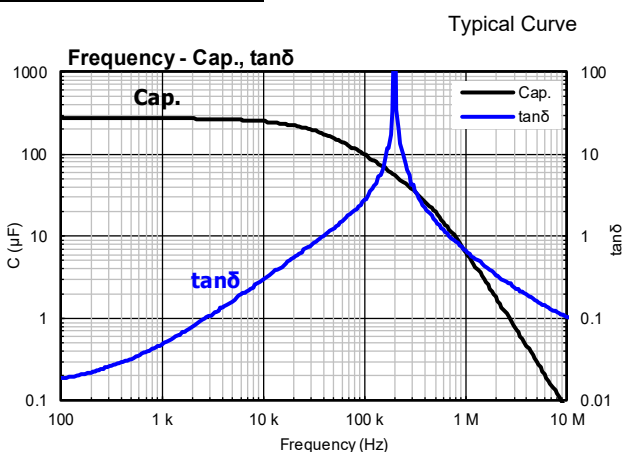
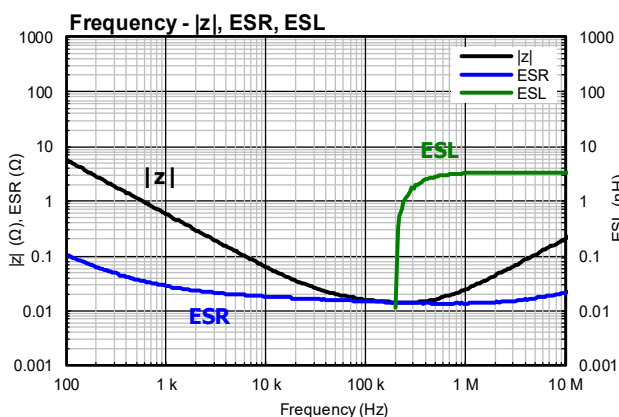

Temperature vs. Capacitance, tanδ, ESR Characteristics

Osc. Level: 0.5 Vrms (at no load)

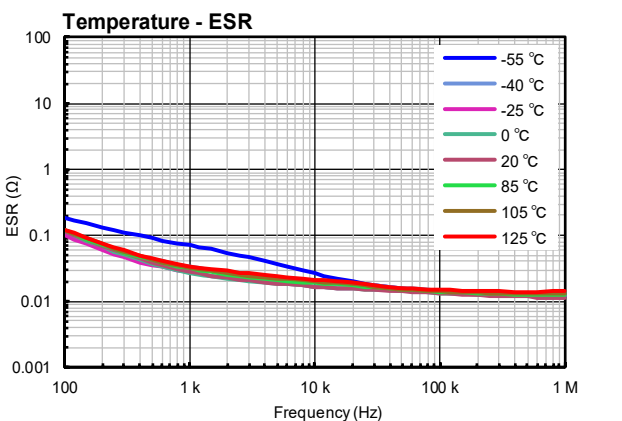
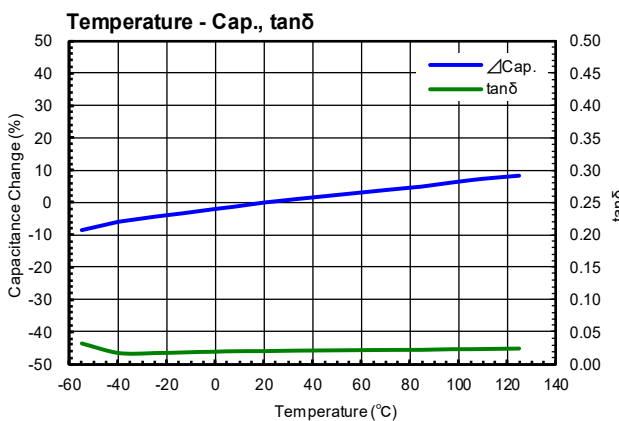

Data Sheet

Conductive Polymer Hybrid Aluminum Electrolytic Capacitor

SMD type ZK series

Part Number : EEHZK1E471P

Endurance: 125 °C, 4000 h

Category Temperature Range	-55 °C to 125 °C
Rated Voltage	25 V
Nominal Capacitance	470 μF (at 120 Hz)
Capacitance Tolerance	±20 %

tan δ	0.14 max. (at 120 Hz)
Leakage Current	117.5 μA max. (at R.V., After 2 min)
ESR	20 mΩ max. (at 100 kHz, 20 °C)
Ripple Current	2800 mA rms max. (at 100 kHz, 125 °C)

Marking

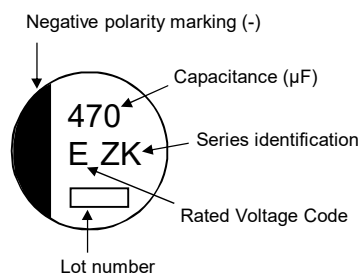

Dimensions in mm (not to scale)

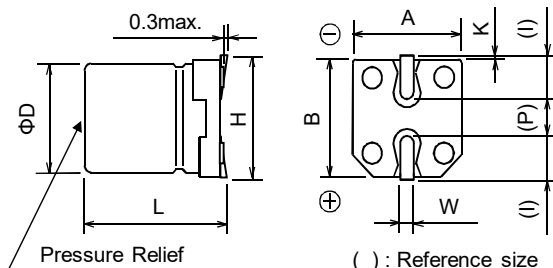

Size Code: G (Unit: mm)

ΦD	10.0 ±0.5
L	10.2 ±0.3
A, B	10.3 ±0.2
H	12.0 max.
I	3.5
W	0.90 ±0.20
P	4.6
K	0.70 ±0.2

Frequency vs. Impedance, ESR, ESL, Capacitance, tanδ Characteristics

Osc. Level: 0.5 Vrms (at no load)

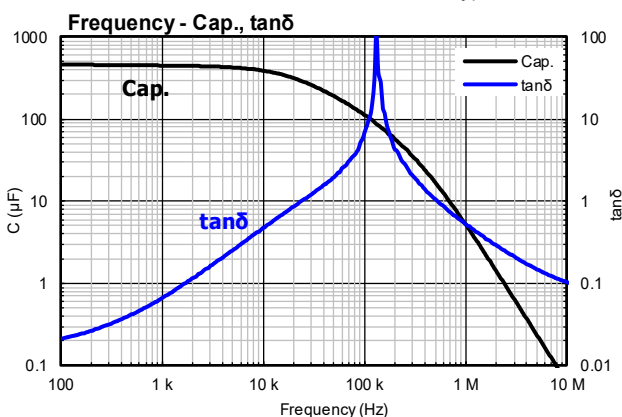
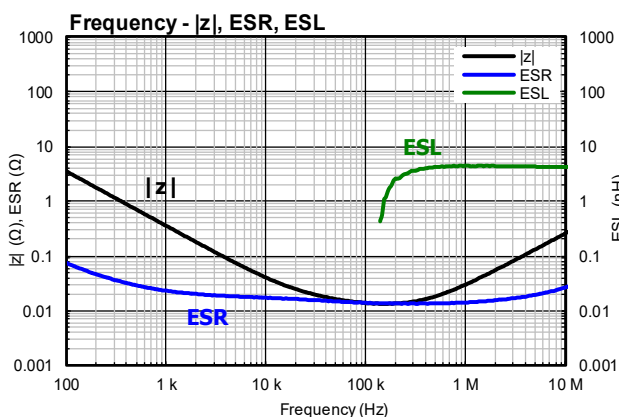

Temperature vs. Capacitance, tanδ, ESR Characteristics

Osc. Level: 0.5 Vrms (at no load)

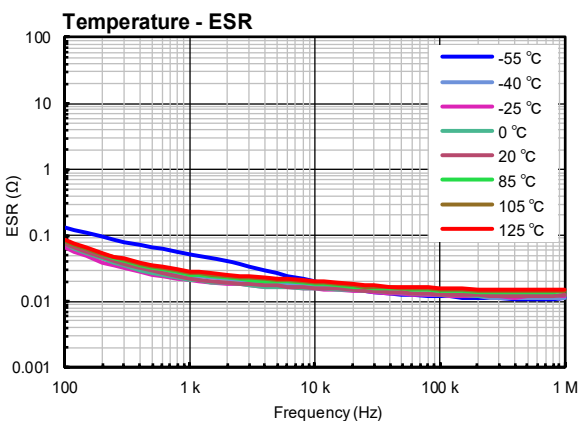
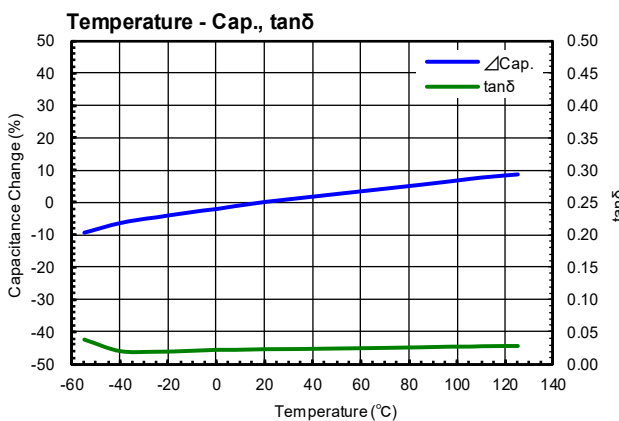

Data Sheet

Conductive Polymer Hybrid Aluminum Electrolytic Capacitor

SMD type ZK series

Part Number : EEHZK1V330R

Endurance: 125 °C, 4000 h

Category Temperature Range	-55 °C to 125 °C
Rated Voltage	35 V
Nominal Capacitance	33 μF (at 120 Hz)
Capacitance Tolerance	±20 %

tan δ	0.12 max. (at 120 Hz)
Leakage Current	11.5 μA max. (at R.V., After 2 min)
ESR	100 mΩ max. (at 100 kHz, 20 °C)
Ripple Current	750 mA rms max. (at 100 kHz, 125 °C)

Marking

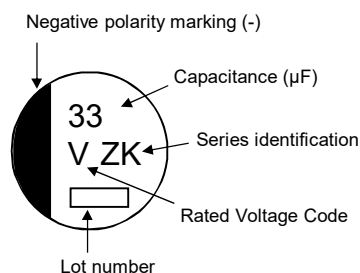

Dimensions in mm (not to scale)

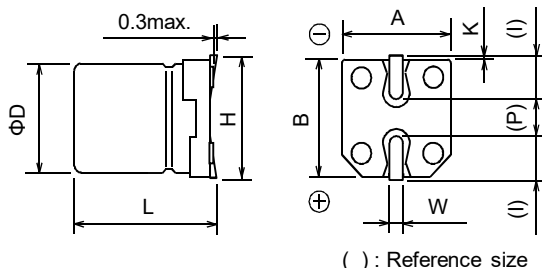

Size Code: C (Unit: mm)

ϕD	5.0 ±0.5
L	5.8 ±0.3
A, B	5.3 ±0.2
H	6.5 max.
I	2.2
W	0.65 ±0.10
P	1.5
K	0.35 +0.15/-0.20

Frequency vs. Impedance, ESR, ESL, Capacitance, tanδ Characteristics

Osc. Level: 0.5 Vrms (at no load)

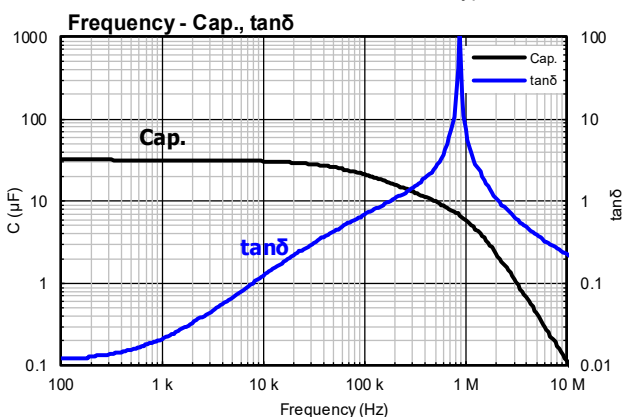
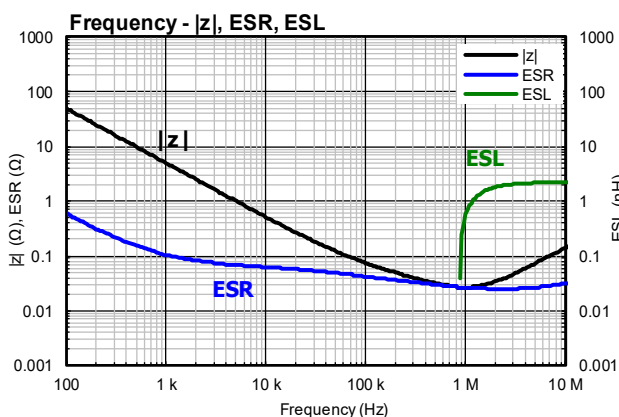

Temperature vs. Capacitance, tanδ, ESR Characteristics

Osc. Level: 0.5 Vrms (at no load)

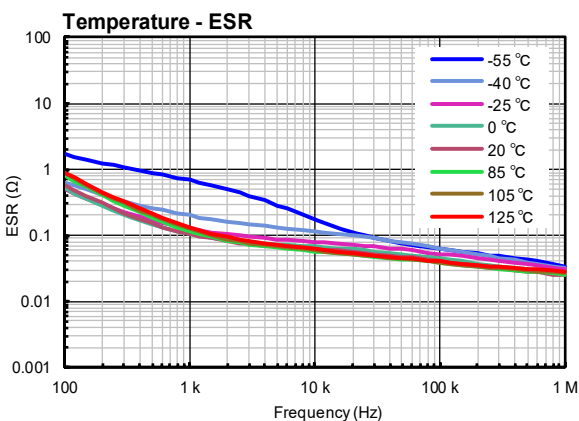
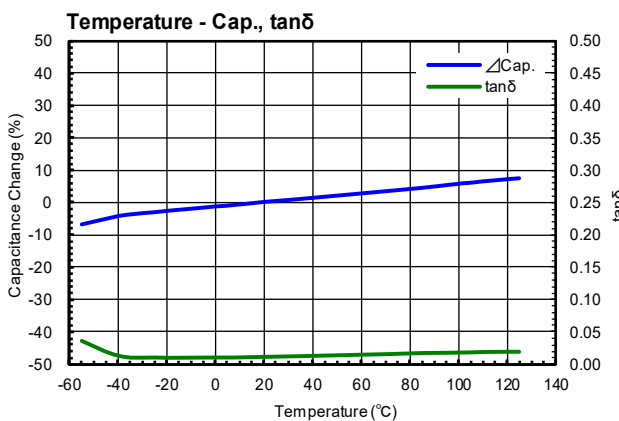

Data Sheet

Conductive Polymer Hybrid Aluminum Electrolytic Capacitor

SMD type ZK series

Part Number : EEHZK1V560P

Endurance: 125 °C, 4000 h

Category Temperature Range	-55 °C to 125 °C
Rated Voltage	35 V
Nominal Capacitance	56 μ F (at 120 Hz)
Capacitance Tolerance	\pm 20 %

$\tan \delta$	0.12 max. (at 120 Hz)
Leakage Current	19.6 μ A max. (at R.V., After 2 min)
ESR	60 m Ω max. (at 100 kHz, 20 °C)
Ripple Current	1200 mA _{RMS} max. (at 100 kHz, 125 °C)

Marking

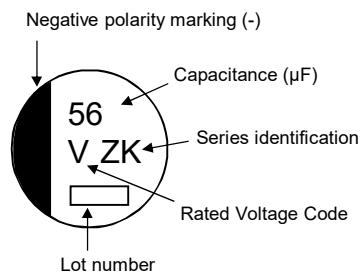

Dimensions in mm (not to scale)

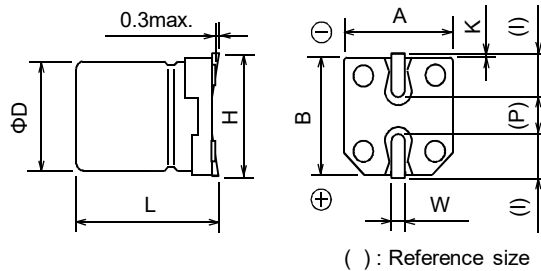

Size Code: D (Unit: mm)

ϕ D	6.3 \pm 0.5
L	5.8 \pm 0.3
A, B	6.6 \pm 0.2
H	7.8 max.
I	2.6
W	0.65 \pm 0.10
P	1.8
K	0.35 +0.15/-0.20

Frequency vs. Impedance, ESR, ESL, Capacitance, $\tan \delta$ Characteristics

Osc. Level: 0.5 V_{rms} (at no load)

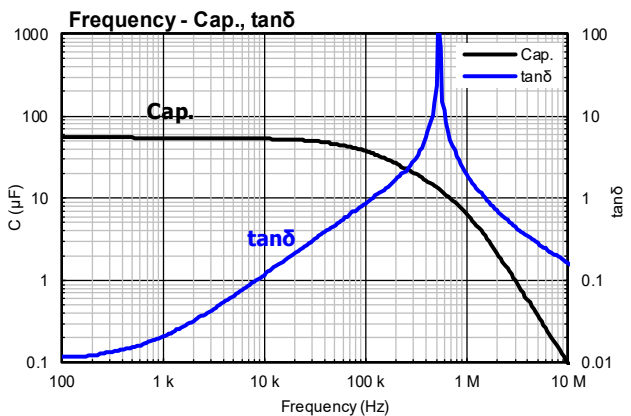
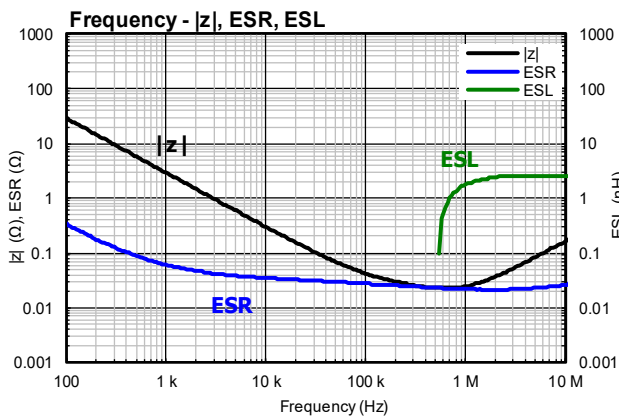

Temperature vs. Capacitance, $\tan \delta$, ESR Characteristics

Osc. Level: 0.5 V_{rms} (at no load)

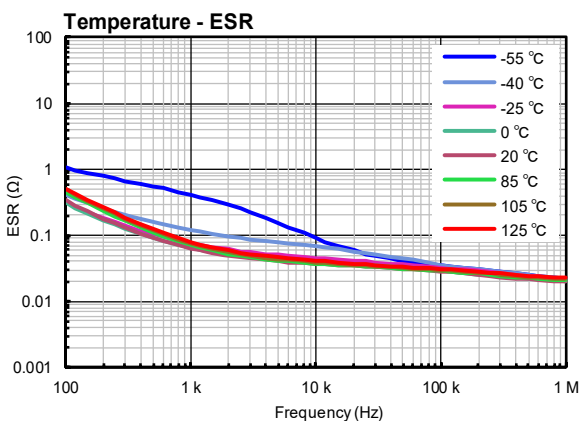
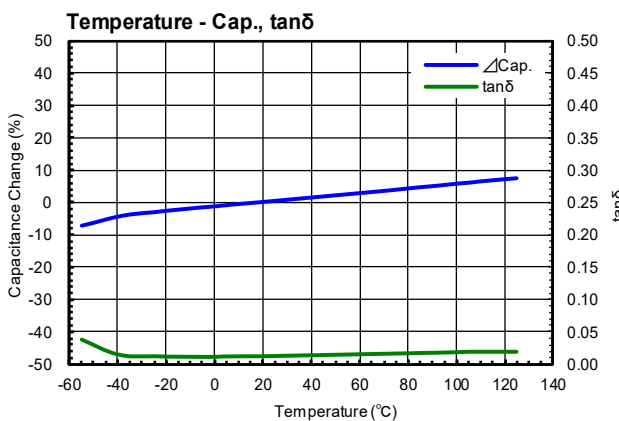

Data Sheet

Conductive Polymer Hybrid Aluminum Electrolytic Capacitor

SMD type ZK series

Part Number : EEHZK1V101XP

Endurance: 125 °C, 4000 h

Category Temperature Range	-55 °C to 125 °C
Rated Voltage	35 V
Nominal Capacitance	100 μF (at 120 Hz)
Capacitance Tolerance	±20 %

tan δ	0.12 max. (at 120 Hz)
Leakage Current	35.0 μA max. (at R.V., After 2 min)
ESR	35 mΩ max. (at 100 kHz, 20 °C)
Ripple Current	1700 mA rms max. (at 100 kHz, 125 °C)

Marking

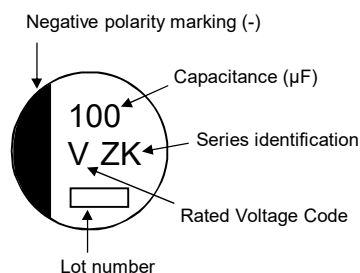

Dimensions in mm (not to scale)

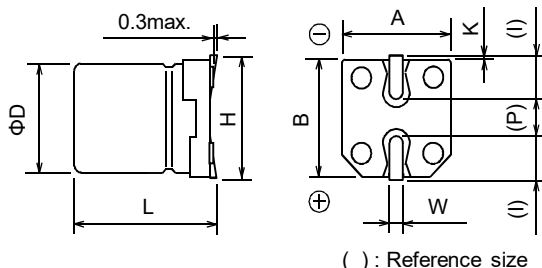

Size Code: D8 (Unit: mm)

ϕD	6.3 ±0.5
L	7.7 ±0.3
A, B	6.6 ±0.2
H	7.8 max.
I	2.6
W	0.65 ±0.10
P	1.8
K	0.35 +0.15/-0.20

Frequency vs. Impedance, ESR, ESL, Capacitance, tanδ Characteristics

Osc. Level: 0.5 Vrms (at no load)

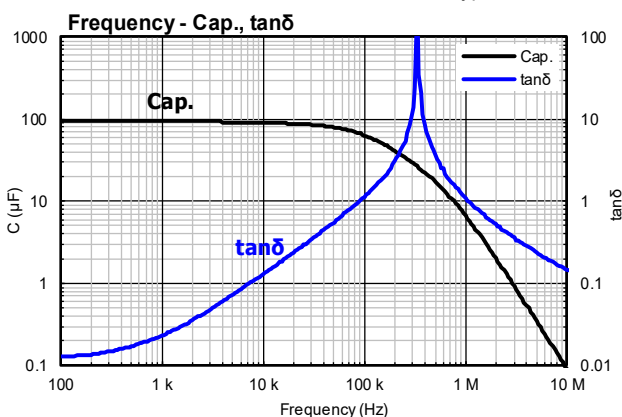
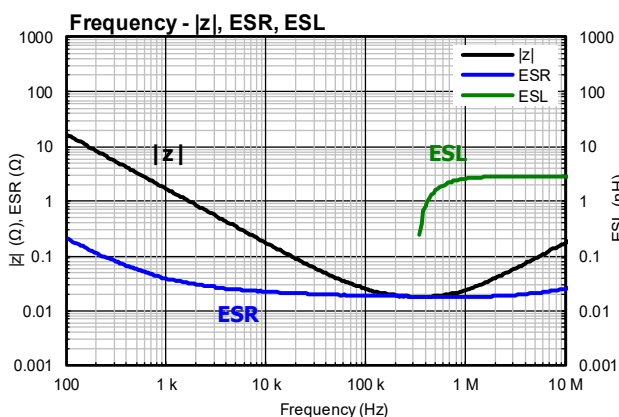

Temperature vs. Capacitance, tanδ, ESR Characteristics

Osc. Level: 0.5 Vrms (at no load)

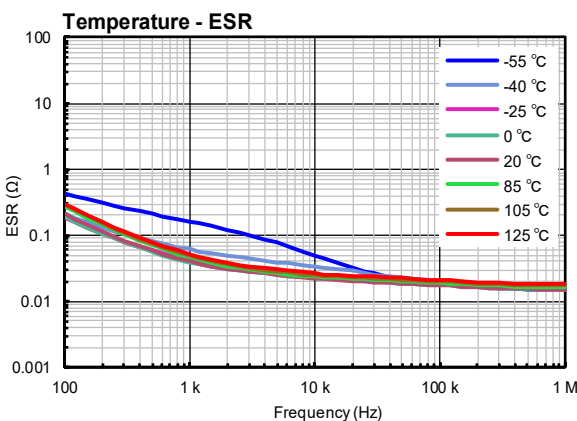
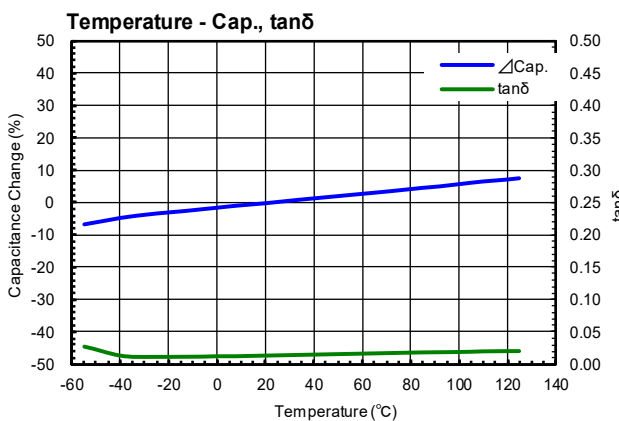

Data Sheet

Conductive Polymer Hybrid Aluminum Electrolytic Capacitor

SMD type ZK series

Part Number : EEHZK1V181P

Endurance: 125 °C, 4000 h

Category Temperature Range	-55 °C to 125 °C
Rated Voltage	35 V
Nominal Capacitance	180 μF (at 120 Hz)
Capacitance Tolerance	±20 %

tan δ	0.12 max. (at 120 Hz)
Leakage Current	63.0 μA max. (at R.V., After 2 min)
ESR	27 mΩ max. (at 100 kHz, 20 °C)
Ripple Current	2000 mA rms max. (at 100 kHz, 125 °C)

Marking

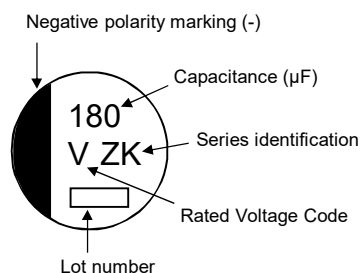

Dimensions in mm (not to scale)

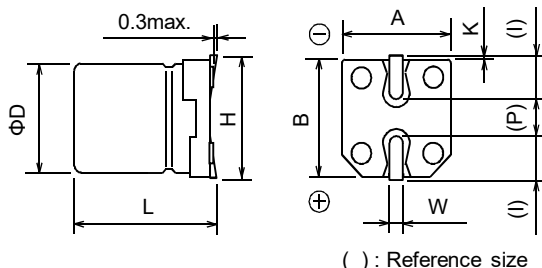

Size Code: F (Unit: mm)

ΦD	8.0 ±0.5
L	10.2 ±0.3
A, B	8.3 ±0.2
H	10.0 max.
I	3.4
W	0.90 ±0.20
P	3.1
K	0.70 ±0.2

Frequency vs. Impedance, ESR, ESL, Capacitance, tanδ Characteristics

Osc. Level: 0.5 Vrms (at no load)

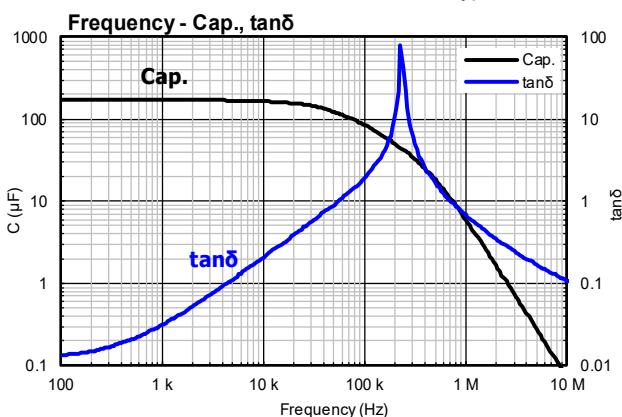
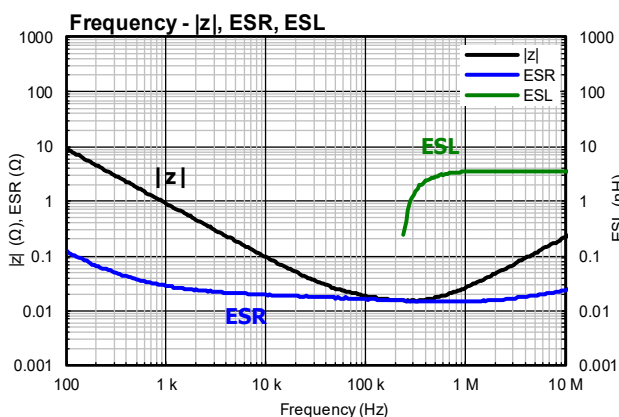

Temperature vs. Capacitance, tanδ, ESR Characteristics

Osc. Level: 0.5 Vrms (at no load)

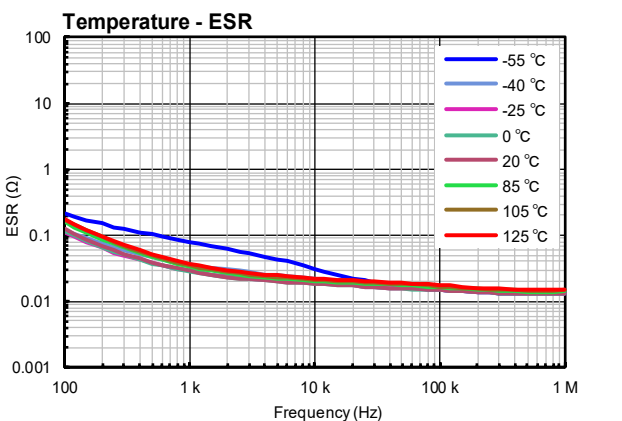
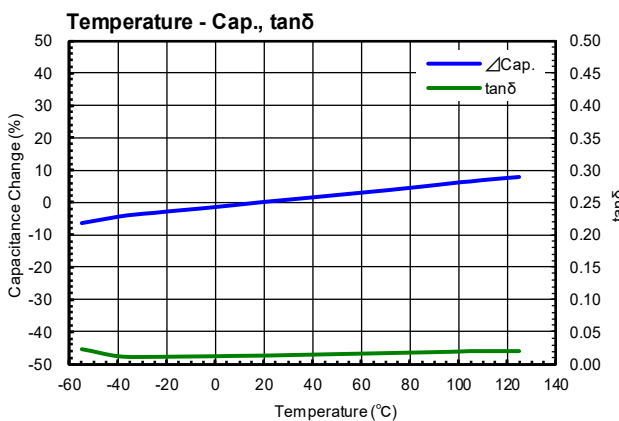

Data Sheet

Conductive Polymer Hybrid Aluminum Electrolytic Capacitor

SMD type ZK series

Part Number : EEHZK1V331P

Endurance: 125 °C, 4000 h

Category Temperature Range	-55 °C to 125 °C
Rated Voltage	35 V
Nominal Capacitance	330 μF (at 120 Hz)
Capacitance Tolerance	±20 %

tan δ	0.12 max. (at 120 Hz)
Leakage Current	115.5 μA max. (at R.V., After 2 min)
ESR	20 mΩ max. (at 100 kHz, 20 °C)
Ripple Current	2800 mA rms max. (at 100 kHz, 125 °C)

Marking

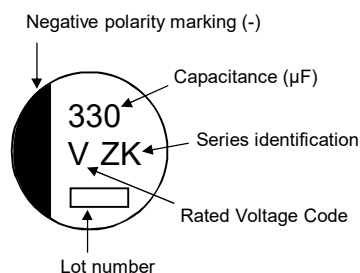

Dimensions in mm (not to scale)

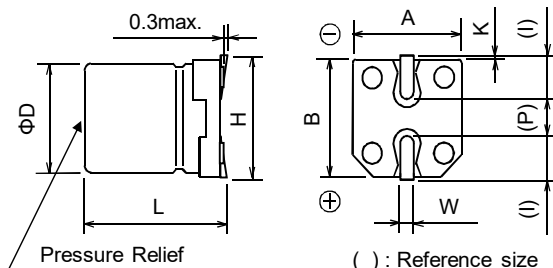

Size Code: G (Unit: mm)

ϕD	10.0 ±0.5
L	10.2 ±0.3
A, B	10.3 ±0.2
H	12.0 max.
I	3.5
W	0.90 ±0.20
P	4.6
K	0.70 ±0.2

Frequency vs. Impedance, ESR, ESL, Capacitance, tanδ Characteristics

Osc. Level: 0.5 Vrms (at no load)

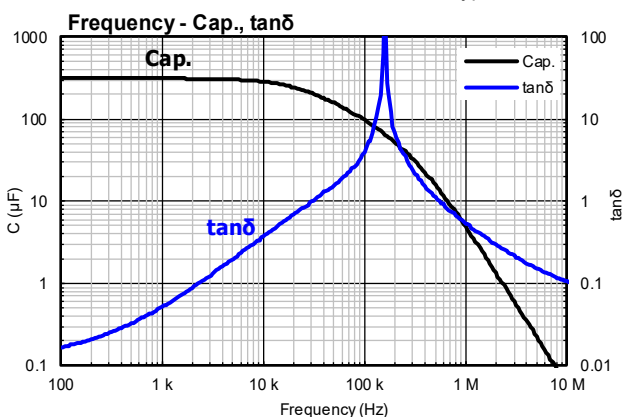
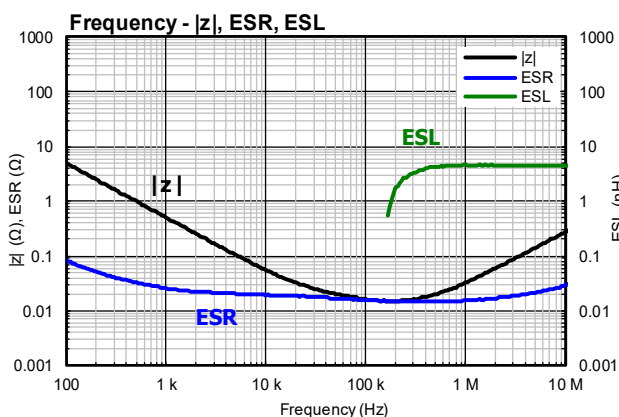

Temperature vs. Capacitance, tanδ, ESR Characteristics

Osc. Level: 0.5 Vrms (at no load)

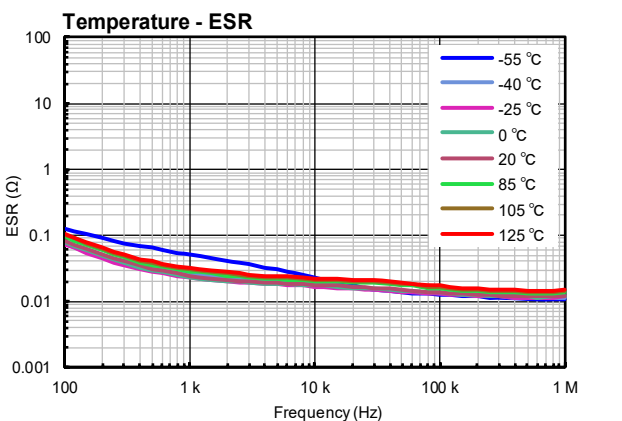
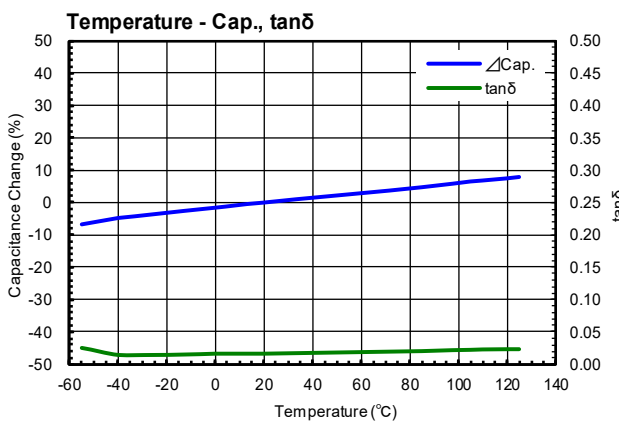

**Conductive Polymer Hybrid
Aluminum Electrolytic Capacitors**

Technical Data ZK series

The first edition : October 1st 2016

The revised edition : April 21, 2020

Issued by Industrial Solutions Company Panasonic Co., Ltd.

Device Solutions Business Division

All rights reserved. No part of this publication may be reproduced or utilized in any form or by any means, electronic or mechanical, including photocopying and microfilm, without permission in writing from the publisher.