

# PY-123NDEUA3



## The features

- Original development of both pump and motor technology  
Customized to optimal shape and performance according to customer needs
- Energy saving with approximately twice the efficiency compared to AC type  
By using molded resin, low noise and low vibration are achieved.
- Flow rate can be varied by PWM control  
The operating status can be checked using the pump impeller rotation speed signal.

## Specifications

Rated voltage	311VDC
Drive power Supply range	280VDC to 373VDC
Variable flow rate signal	0VDC to 6VDC (voltage Control)
Range of rated Power consumption	149W to 201W (at rated voltage)
Operating temperature	-20℃ to 80℃ (Without any freezing)
Ambient temperature	-20℃ to 60℃
Protection grade	IPX4
Size	W117×H122×D107mm
Weight	1.3kg

## Dimensions

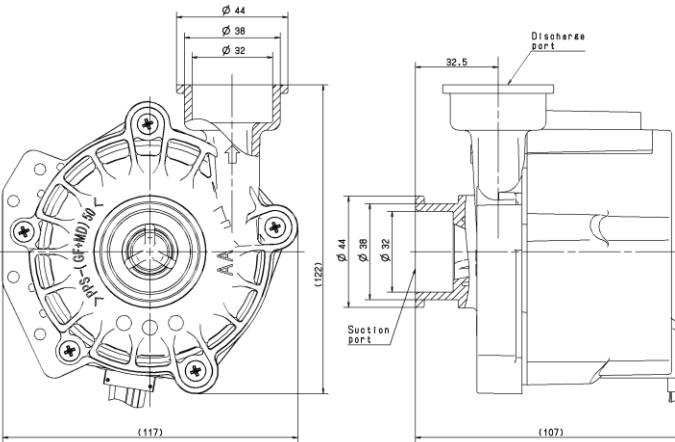

- [Pipe Connection]
- Suction :  
Clip fastening type/ Inner diameter of joint:  $\phi$  32mm
  - Discharge :  
Clip fastening type/ Inner diameter of joint:  $\phi$  32mm

## Characterics (Reference)

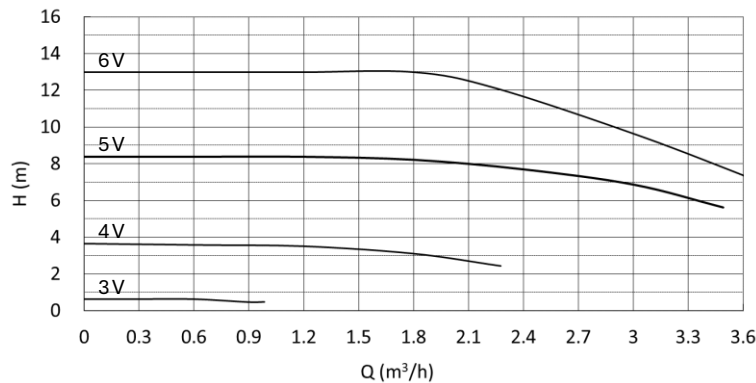

The pump performance curves shown above indicate actual measurements when a drive voltage of 311VDC and variable flow-rate signals are applied. Circulating water temperature is 20℃.

## Electrical interfaces

