

**Mounting specification**

● Recommendable reflow soldering

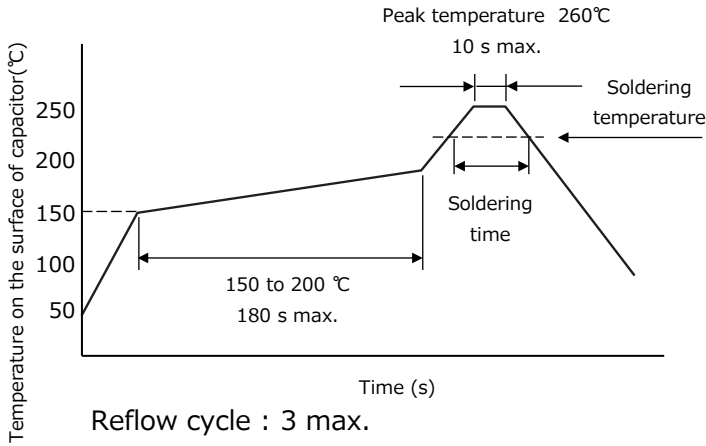

Soldering temperature and soldering time

Temperature	Time
≥ 255°C	30 s max.
≥ 230°C	130 s max.
≥ 217°C	150 s max.

SP-Cap recommended profile condition of the IPC/J-STD-020D standard

● Typical land pattern

- 2-terminals  
For standard terminal (C\*, S\*, G\*, HX series)

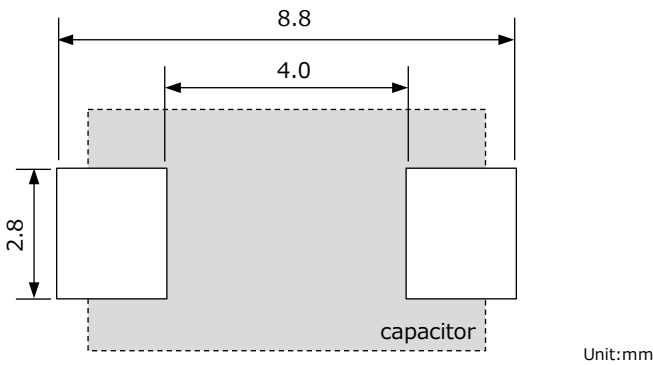

- 3-terminals  
For low ESL terminal (L\*, GX-L series)

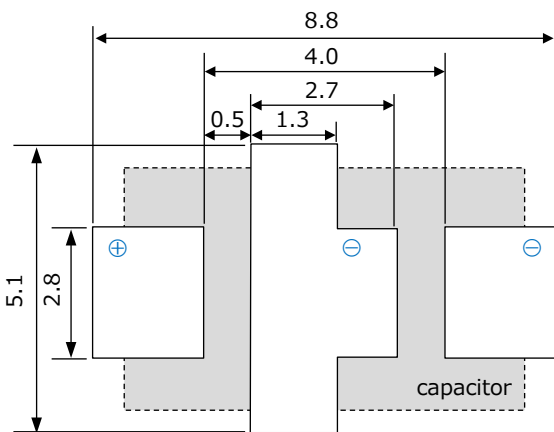

- 〈VIA〉  
For low ESL terminal (L\*, GX-L series)

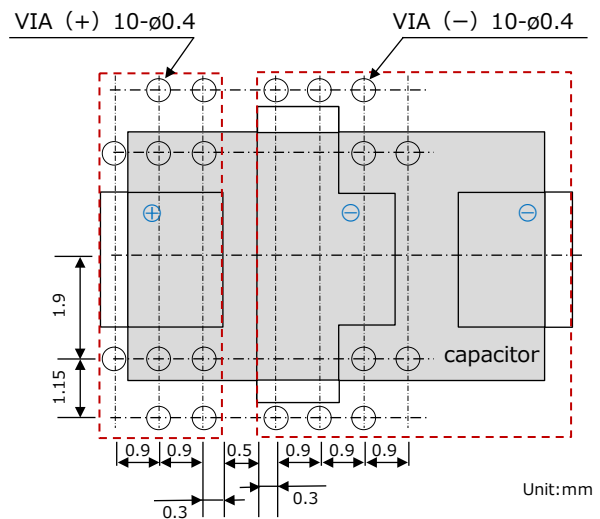

**Packaging specifications**

● Reel dimensions

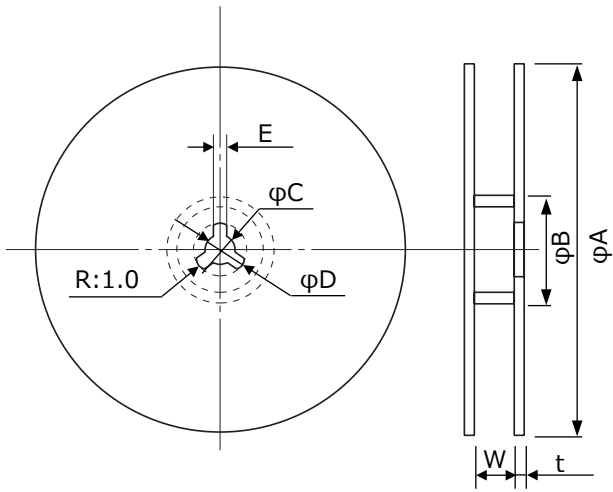

Unit:mm							
Reel	$\phi A$	$\phi B$	$\phi C$	$\phi D$	E	W	t
$\phi 330$	330	80	$13 \pm 0.5$	$21 \pm 0.8$	$2 \pm 0.5$	14	3
$\phi 180$	180	60	$13 \pm 0.5$	$21 \pm 0.8$	$2 \pm 0.5$	14	3

● Embossed taping (12mm tape)

(12mm tape)

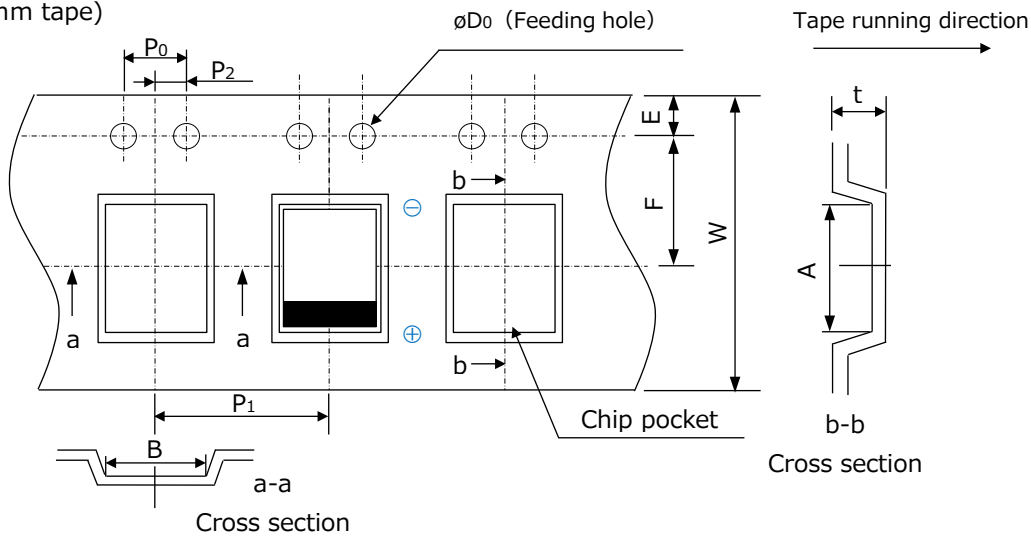

Unit:mm					
A	B	W	F	E	P <sub>1</sub>
$7.6 \pm 0.2$	$4.5 \pm 0.2$	$12 \pm 0.3$	$5.5 \pm 0.1$	$1.75 \pm 0.1$	$8.0 \pm 0.1$
P <sub>2</sub>	P <sub>0</sub>	$\phi D_0$	Upper row : Product height / Lower berth : t		
			to 1.1	1.4 to 1.9	2.8
$2.0 \pm 0.1$	$4.0 \pm 0.1$	$1.5 \begin{smallmatrix} +0.1 \\ 0 \end{smallmatrix}$	$1.5 \pm 0.2$	$2.4 \pm 0.2$	$3.5 \pm 0.2$

● Packaging box dimensions

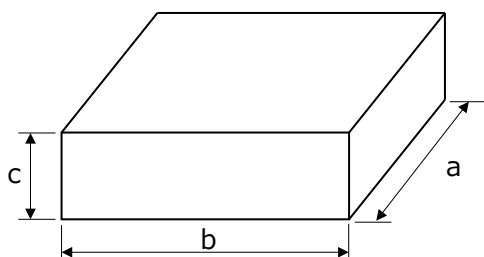

Unit:mm			
Reel	a	b	c
$\phi 330$	400 max.	400 max.	135 max.
$\phi 180$	320 max.	240 max.	135 max.