

### Switching Transformers for Current Resonance Power Supplies

Japan  
Singapore  
Indonesia  
China

Type: **CR**

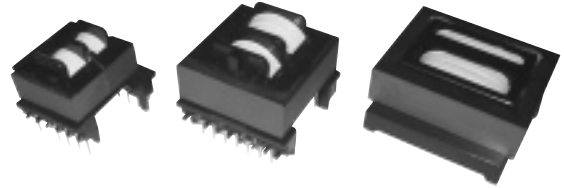

Separate bobbin structures for the primary and secondary wires.  
Recommended for current resonance power supplies.

Applied Safety Std.: Denki Yohin\* UL, CSA, Europe's Class II  
Industrial Property : Utility models 17 (pending)

#### ■ Features

- Strengthens the insulation between the primary and secondary wires
- Low loss

#### ■ Recommended Applications

- Resonance power supplies
- Flat-screen televisions, Printers, LBPs

#### ■ Explanation of Part Numbers

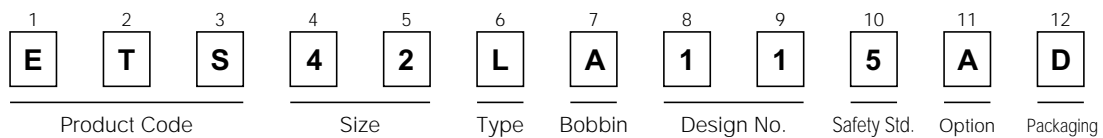

### ■ Performance Characteristics

- Applicable Safety Standards and Maximum Output

Size	Characteristics	Standards		Max. Output (W)
		Denki Yohin* UL, CSA	Europe's Class II IEC65	Current Resonance Type f=100 kHz
28		○	○	120
35		○	○	200
42		○	○	300
49		○	○	400
57		○	○	300

### ■ Dimensions in mm (not to scale)

28CR-14

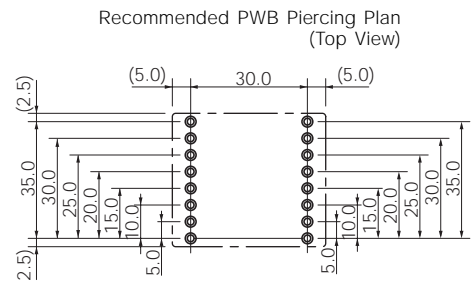
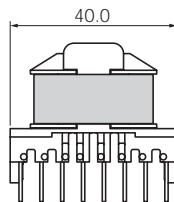
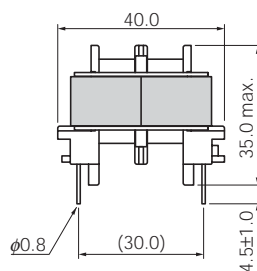

35CR-13

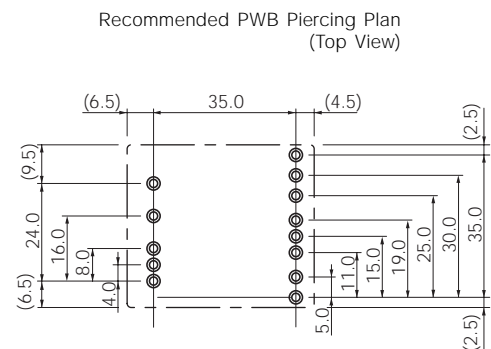
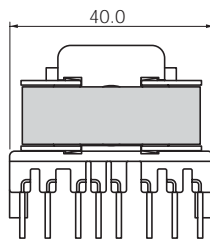
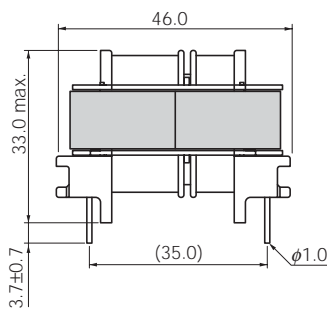

42CR-18

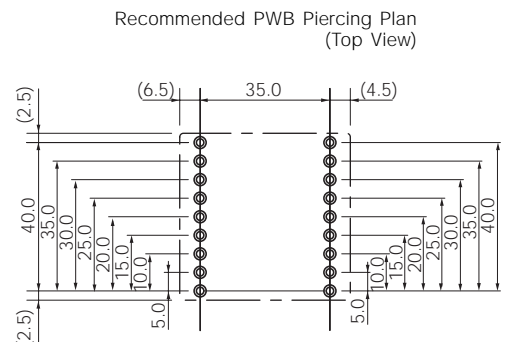
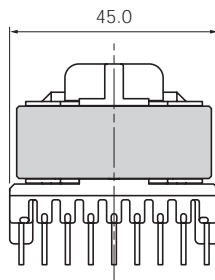
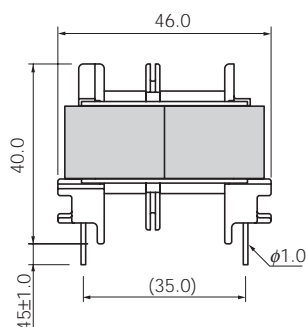

■ Dimensions in mm (not to scale)

49CR-17

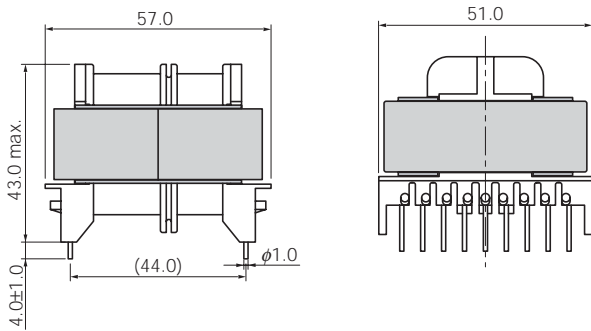

Recommended PWB Piercing Plan (Top View)

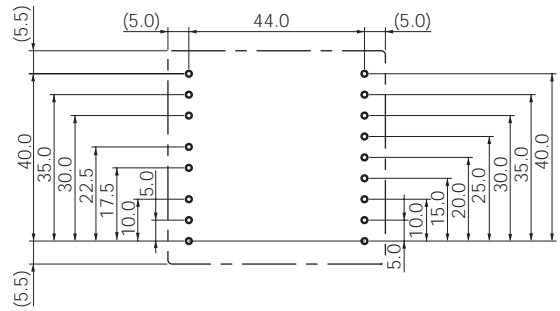

57CR-17

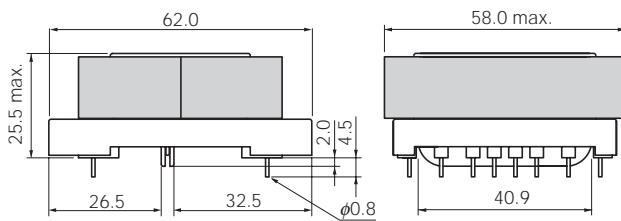

Recommended PWB Piercing Plan (Top View)

