

SMD Choke Coils

Series: **U**  
 Type: **ELL3FU**



Type ELL3FU

■ Features

- A high performance is achieved by improvement of winding space factor by the rectangular wire and the original winding industrial method  
 High performance was actualized by the application of flat wire winding and ring coreless structure
- The magnetic shield effect is provided by adhesive with magnetic materials structure
- Low profile

■ Recommended Applications

- Choke coil for smoothness of DC/DC of mobile device
- Mobile Phone, DSC, HDD, MID, Net-Book

■ Standard Packing Quantity

- 2000 pcs./Reel

■ Explanation of Part Numbers

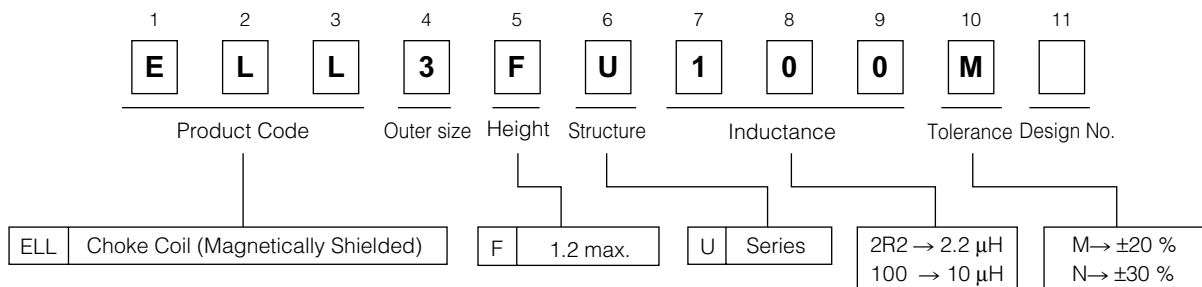

■ Dimensions in mm (not to scale)

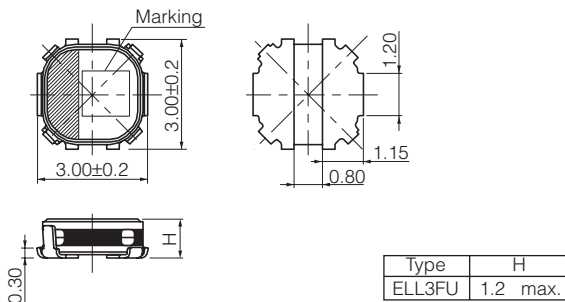

■ Recommended land patterns in mm (not to scale)

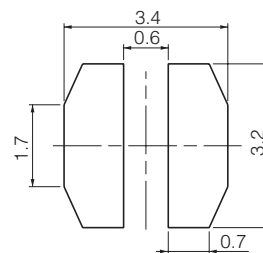

### Standard Parts

Part Number	Inductance (100 kHz)		RDC (at 20 °C)		Saturation Rated Current* <sup>1</sup> (mA max.)	Rated Current* <sup>2</sup> (mA max.)
	(μH)	Tol.	(mΩ)	Tol.		
ELL3FU1R0N	1.0	±30 %	48	±20 %	1700	1700
ELL3FU2R2N	2.2		77		1450	1500
ELL3FU3R3N	3.3		88		1150	1400
ELL3FU4R7N	4.7		130		950	1050
ELL3FU100M	10.0	±20 %	290		600	710

\*1 Saturation Rated Current: This DC current which causes a 20% inductance reduction from its nominal value.

\*2 Rated current defines actual value of DC current, when temperature rise of coil becomes 40K

### Embossed Carrier Tape Dimensions in mm (not to scale)

